

SALES & ENGINEERING DATA

| | |
|---------------------|-----------------|
| RATIO SERIES: | 1:1 |
| FLUID P.S.I. RANGE: | 10 - 100 |

PD03P-XXS-XXX

3/8" NON-METALLIC DIAPHRAGM PUMP

RELEASED: 2-17-06
 REVISED: 12-21-06
 (REV. 02) S-1386

DIMENSIONAL DATA

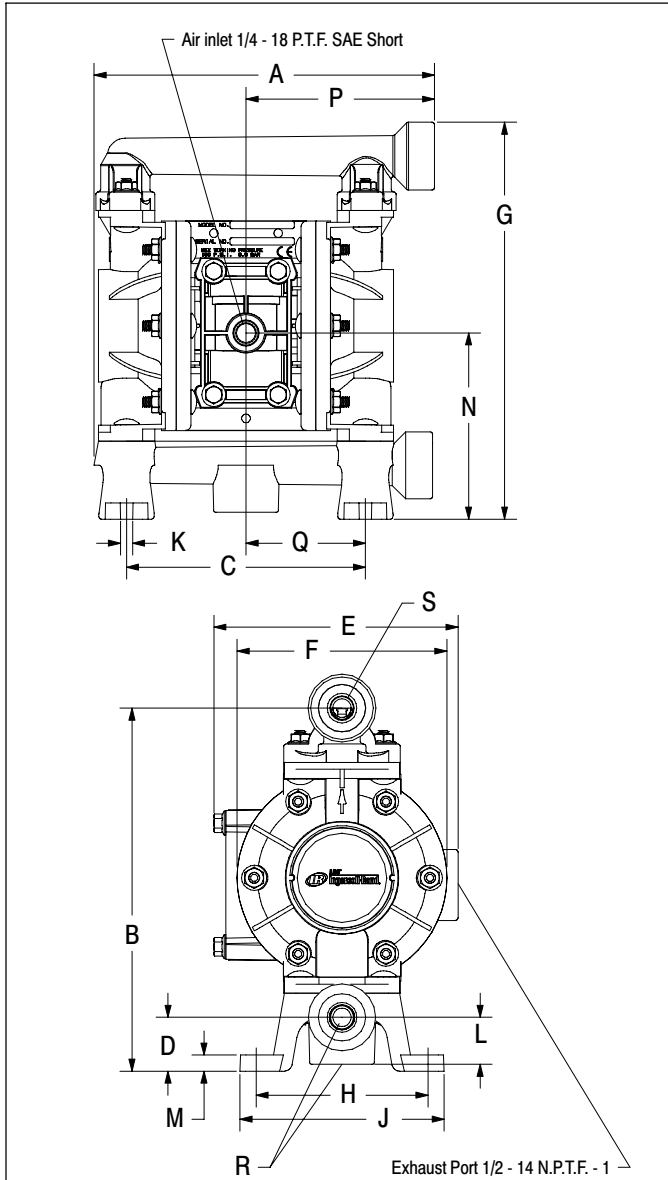

DIMENSIONS

| | | |
|-----------------------|-----------------------|-----------------------|
| A 7-31/32" (202.3 mm) | F 4-31/32" (125.6 mm) | L 1-3/32" (27.8 mm) |
| B 8-17/32" (216.1 mm) | G 9-5/16" (236.2 mm) | M 3/8" (9.6 mm) |
| C 5-5/8" (142.7 mm) | H 4-1/16" (102.7 mm) | N 4-3/8" (111.0 mm) |
| D 1-9/32" (32.1 mm) | J 4-13/16" (121.9 mm) | P 4-13/32" (110.5 mm) |
| E 5-23/32" (145.2 mm) | K 9/32" (7.2 mm) | Q 2-13/16" (71.4 mm) |

| | | |
|------------------------|---------------------------|----------------------------|
| <u>Model</u> | <u>"R" Material Inlet</u> | <u>"S" Material Outlet</u> |
| PD03P- <u>A</u> XS-XXX | 3/8 - 18 N.P.T.F. - 1 | 3/8 - 18 N.P.T.F. - 1 |
| PD03P- <u>B</u> XS-XXX | Rp 3/8 (3/8 - 19 BSP) | Rp 3/8 (3/8 - 19 BSP) |

NOTE: Dimensions are shown in inches and (mm), supplied for reference only and are typically rounded up to the nearest 1/16 inch.

SPECIFICATIONS

CONSTRUCTION

| | |
|---|--|
| Model Series | PD03P-XXS-XXX |
| Pump Type | Non-Metallic, Air Operated, Double Diaphragm |
| Ratio | 1:1 |
| Material Inlet / Outlet (female) | |
| PD03P- <u>A</u> XS-XXX | 3/8 - 18 N.P.T.F. - 1 |
| PD03P- <u>B</u> XS-XXX | Rp 3/8 (3/8 - 19 BSP parallel) |
| Air Inlet (female) | 1/4 - 18 P.T.F. SAE short |
| Air Exhaust (standard) | internal |
| (optional)(female) | 1/2 - 14 N.P.T.F. - 1 |
| Weight .. | |
| PD03P- <u>XDS</u> -XXX | 4.16 lbs (1.89 kgs) |
| PD03P- <u>XES</u> -XXX | 4.26 lbs (1.93 kgs) |
| PD03P- <u>XKS</u> -XXX | 4.50 lbs (2.04 kgs) |
| PD03P- <u>XLS</u> -XXX | 4.62 lbs (2.10 kgs) |
| PD03P- <u>XPS</u> -XXX | 3.44 lbs (1.56 kgs) |
| PD03P- <u>XRS</u> -XXX | 3.50 lbs (1.59 kgs) |
| Air Section Service Kit | 637428 |
| Fluid Section Service Kit | 637429-XX |

PD03P-XXS- X X X
 637429 - X X X
 └─ Diaphragm Material
 └─ Ball Material

EXAMPLE: Model #PD03P-ARS-SAA
 Fluid Section Service Kit is 637429-AA

PERFORMANCE

| | |
|--|----------------------------------|
| Air Inlet Pressure Range | 10 - 100 p.s.i. (0.69 - 6.9 bar) |
| Maximum Material Inlet Pressure .. | 10 p.s.i. (0.69 bar) |
| Fluid Outlet Pressure Range | 10 - 100 p.s.i. (0.69 - 6.9 bar) |
| Maximum Flow Rate (flooded inlet) .. | 10.6 g.p.m. (40.1 l.p.m.) |
| Displacement / Cycle @ 100 p.s.i. .. | 0.022 gal. (0.083 lit.) |
| Maximum Particle Size | 1/16" dia. (1.6 mm) |
| Maximum Temperature Limits (diaphragm / ball / seat material) | |
| Acetal | 10° to 180° F (-12° to 82° C) |
| Hytrek | -20° to 150° F (-29° to 66° C) |
| Polypropylene | 35° to 150° F (2° to 66° C) |
| Kynar PVDF | 10° to 200° F (-12° to 93° C) |
| Santoprene | -40° to 225° F (-40° to 107° C) |
| Teflon PTFE | 40° to 225° F (4° to 107° C) |
| Viton | -40° to 350° F (-40° to 177° C) |
| Noise Level @ 70 p.s.i. - 60 c.p.m. ... | 72.7 db(A) ^① |

Notes:

① The pump sound pressure level has been updated to an Equivalent Continuous Sound Level (L_{Aeq}) to meet the intent of ANSI S1. 13-1971, CAGI-PNEUROP S5.1 using four microphone locations.

ACCESSORIES:

- 66073-1 Air Line Connection Kit
- 67388 Wall Mount Bracket Assembly
- 93110 Muffler
- 637438 Ported Exhaust Kit

PERFORMANCE CURVES

PD03P-XXS-XXX 3/8" NON-METALLIC DIAPHRAGM PUMP

